



# Automate Motor Programming Guide



1. ASSEMBLY
Please refer to separate Rollease Acmeda System Assembly Manual for full assembly instructions relevant to the hardware system being used.
2. BATTERY MANAGEMENT
For battery motors: Prevent discharging the battery completely for extended periods, recharge as soon as the battery is discharged
CHARGING NOTES
Before first use please charge motor for 6-16 hours, using the recommended AC charger
<div></div> During operation, if battery is low, the motor will beep 10 times to prompt the user it needs charging.
3. PRODUCT RANGE
The Quick Start Programming Guide is universal for all Automate Motors including:
<div></div> Internal Tubular
<div></div> Large Tubular

3. PRODUCT RANGE (cont.)
<div></div> 0.6 Cord Lift
<div></div> 0.8 Cord Lift
<div></div> Curtain
<div></div> Tilt Motor
<div></div> <b>Note:</b> Curtain motor does not Jog but instead LED flashes. DC motor does not beep.
DISPOSAL AND RECYCLING
<div></div> Do not dispose of in general waste.

INSTALLER BEST PRACTICE AND TIPS
SLEEP MODE
If pre-programmed: before shipping the motor ensure the motor is put into sleep mode so it doesn't activate during transit.
LOCK REMOTE
Prevent users accidentally changing the limit; ensure the remote is locked as your last step of programming.
ZONE / GROUPS
Ask the customer the day before to think how shades will be zoned on the remote. This may save an extra call out.
SETTLE FABRIC
Run the fabric up and down several times to ensure fabric has settled to some extent and re adjust the limits if needed.
CHARGE 100%
For battery motors ensure the motor is fully charged as per instructions.
INSTALLERS REMOTE
Use a spare remote to individually program each shade. Then use that remote to group rooms as per the user's needs. If you go back and service the installation later then, that same remote can be used to check the individual shades.
<div></div> <div></div>

P1 LOCATIONS
<div></div> Internal Tubular
<div></div> 0.6 Cord Lift
<div></div> Curtain
<div></div> Large Tubular

<div></div> 0.8 Cord Lift
<div></div> Tilt Motor
SAFETY
<b>WARNING: Important safety instructions to be read before installation and use.</b>  Incorrect installation or use can lead to serious injury and will void manufacturer's liability and warranty. It is important for the safety of persons to follow the enclosed instructions. <i>Save these instructions for future reference.</i>  <ul style="list-style-type: none"><li>• Do not expose to water, moisture, humid and damp environments or extreme temperatures.</li><li>• Persons (including children) with reduced physical, sensory or mental capabilities, or lack of experience and knowledge, should not be allowed to use this product.</li><li>• Use or modification outside the scope of this instruction manual will void warranty.</li><li>• Installation and programming to be performed by a suitably qualified installer.</li><li>• Follow installation instructions.</li><li>• For use with motorized shading devices.</li><li>• Keep away from children.</li><li>• Frequently inspect for improper operation.</li></ul> Do not use if repair or adjustment is necessary. • Keep clear when in operation. • Replace battery with correctly specified type.

CAUTION
This device complies with Part 15 of the FCC Rules / Innovation, Science and Economic Development Canada's licence-exempt RSSI(s). Operation is subject to the following two conditions: (1) this device may not cause harmful interference. (2) this device must accept any interference received, including interference that may cause undesired operation.  L'émetteur/récepteur exempt de licence contenu dans le présent appareil est conforme aux CNR d'Innovation, Sciences et Développement économique Canada applicables aux appareils radio exempts de licence. L'exploitation est autorisée aux deux conditions suivantes : 1. L'appareil ne doit pas produire de brouillage; 2. L'appareil doit accepter tout brouillage radioélectrique subi, même si le brouillage est susceptible d'en compromettre le fonctionnement.  Changes or modifications not expressly approved by the party responsible for compliance could void the user's authority to operate the equipment.
This equipment has been tested and found to comply with the limits for a Class B digital device, pursuant to part 15 of the FCC Rules. These limits are designed to provide reasonable protection against harmful interference in a residential installation. This equipment generates uses and can radiate radio frequency energy and, if not installed and used in accordance with the instructions, may cause harmful interference to radio communications. However, there is no guarantee that interference will not occur in a particular installation. If this equipment does cause harmful interference to radio or television reception, which can be determined by turning the equipment off and on, the user is encouraged to try to correct the interference by one or more of the following measures:  <ul style="list-style-type: none"><li>• Reorient or relocate the receiving antenna.</li><li>• Increase the separation between the equipment and receiver.</li><li>• Connect the equipment into an outlet on a circuit different from that to which the receiver is connected.</li><li>• Consult the dealer or an experienced radio/TV technician for help.</li></ul>

# INSTALLER QUICK START PROGRAMMING

## STEP 1 ON REMOTE

Press ◀ or ▶ buttons to select the channel that needs to be programmed

## STEP 2 PAIRING REMOTE WITH MOTOR

2 SECS

\* Internal Tubular pictured. Refer to "P1 Locations" for specific devices

Press the **P1 button** on the motor for **2 Seconds** until the motor responds

The motor will respond with 1x Jog & 1x Beep

Within 4 seconds hold the stop button on the remote until the motor responds as below:

2 SECS

## STEP 3 CHECK DIRECTION

OR

Press **up or down** to check the motor direction. If correct skip to **step 5**.

## STEP 4 CHANGE DIRECTION

Reversing motor direction using this method is only possible during initial set-up.

## STEP 5 SET UPPER LIMIT

Move shade to desired top limit by pressing the **up arrow** repeatedly. Then press and hold **up & stop together 2 seconds** to save limit.

Tap the arrow several times or hold down if needed; press arrow to stop.

## STEP 6 SET BOTTOM LIMIT

Move shade to desired bottom limit by pressing the **down arrow** repeatedly. Then press and hold **down & stop together for 2 seconds** to save limit.

Tap the arrow several times or hold down if needed; press arrow to stop.

## STEP 7 SAVE YOUR LIMIT

Repeat steps 1-6 for all motors. Once complete **Push the switch up** to lock the remote, the **L** will briefly appear on the screen.

## FACTORY RESET MOTOR RESET PROCEDURE

To reset all settings in the motor press and hold the **P1 Button for 14 seconds**, you should see **4 independent jogs** followed by **4x Beeps** at the end.

14 SECS

\* Internal Tubular pictured above. Refer to "P1 Locations" for specific devices

### MOTOR RESPONSE

2 SECS

6 SECS

10 SECS

14 SECS



# USER GUIDE

## QUICK START GUIDE

### BUTTON OVERVIEW

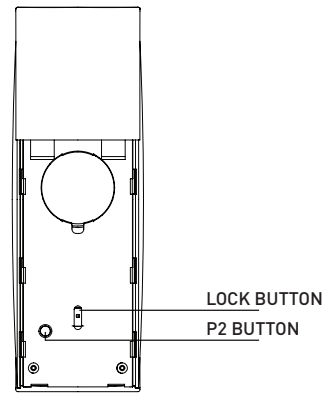
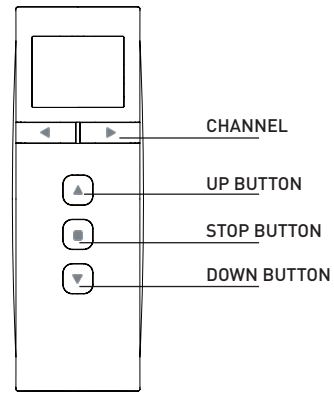

### REPLACE BATTERY

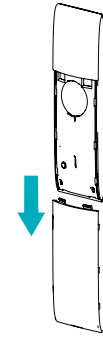

Remove cover from remote press gently in and down to disengage cover.

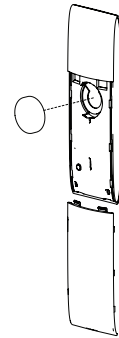

Install battery CR2450 with positive (+) side facing up.

### WALL MOUNTING

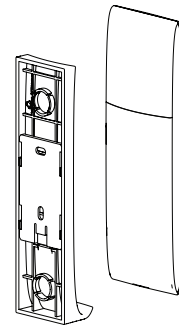

Use supplied fasteners and anchors to attach the base to wall.

### HIDE SPARE CHANNELS

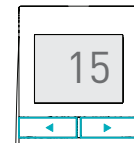

Press and hold both channel scroll buttons together until 15 appears on the screen.



scroll with the left arrow from ch 15 until you reach the last channel that you want to see (example 5) confirm by pressing stop Ch 1 -5 will only be visible

### SELECTING A CHANNEL

#### STEP 1



Press left and right arrow; to scroll through channels as required.

#### STEP 2

##### READY FOR CONTROL

Now while the channel is active follow the control instructions.

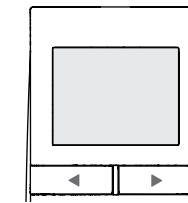

if no button is pressed within 4 seconds, the channel selection will automatically be confirmed.

### GROUP CONTROL

Channel "0" is pre-set to control ALL shades paired to your Multi-channel remote.

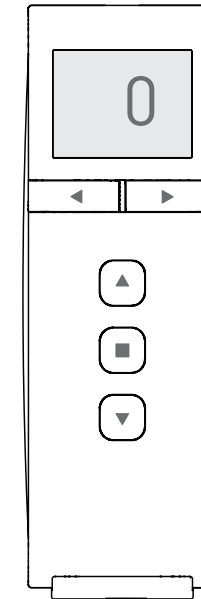

### CONTROLLING A SHADE

#### CONTROL SHADE UP OR DOWN

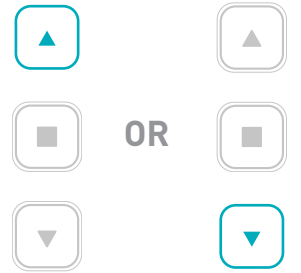

While the channel is displayed press up or down to move shade accordingly

#### STOPPING THE SHADE



Press the stop button to stop shade at any point

# USER GUIDE

## ADVANCED PROGRAMMING

### DISABLE LIMIT SETTING

This mode is intended to be used after all shade programming is completed. User Mode will prevent accidental or unintended changing of limits.

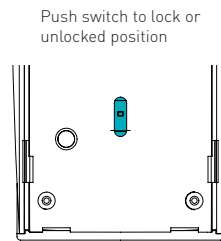

LCD displays "L" when locked

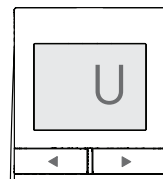

LCD displays "U" when unlocked

### SET A FAVORITE POSITION

Repeating these steps after creating a favorite position will delete it.

Move shade to desired position by pressing **UP** or **DOWN** on the remote.

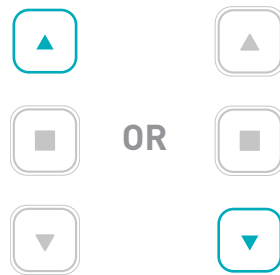

#### STEP 1. Press P2 on controller

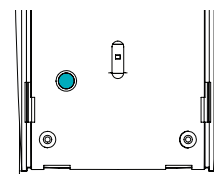

MOTOR RESPONSE



#### STEP 2. Press STOP on controller



MOTOR RESPONSE



#### STEP 3. Press STOP on controller



MOTOR RESPONSE

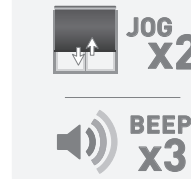

### CREATE CUSTOM GROUPS

It is possible to copy one channel to another channel to create custom groups

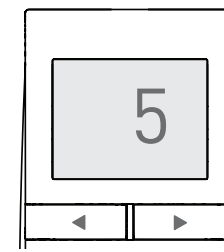

Select the channel you want to transfer

#### STEP 1. Press P2 on existing controller

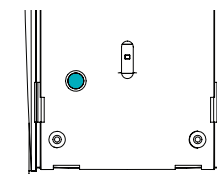

MOTOR RESPONSE



#### STEP 2. Press P2 again on existing controller

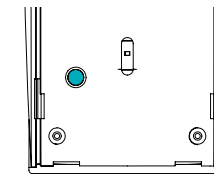

MOTOR RESPONSE



Step 3 to be completed within 4 seconds of Step 2

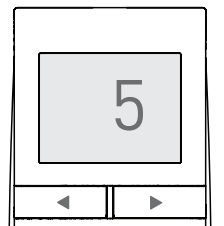
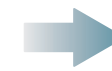

Select the channel on the new controller

#### STEP 3. Press P2 on new controller

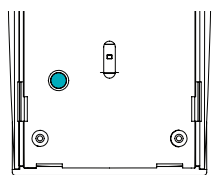

MOTOR RESPONSE

