

Measuring Guide for Fabric Wrapped Cornices

Double-check your work—always measure twice to ensure accuracy.

Tools and Tips

- Steel tape measure — do not use cloth tape
- Pencil
- Round measurements to the nearest $\frac{1}{8}$ "

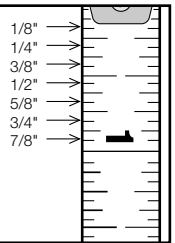

Premium Fabric-Wrapped Cornices

Measure Notes:

- An inside mount cornice has a depth of 3" (mounting board/dust cover)
- Measure depth of window casing to determine if it will accommodate an inside mount
- Determine inside or outside mount
- Face width will be approximately $1\frac{1}{2}$ " wider than the ordered width
- Inside mount will be approximately $\frac{1}{2}$ " less than the ordered width

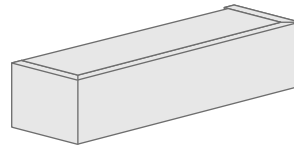

Outside Mount (side view)

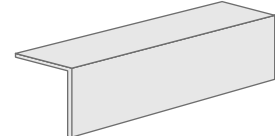

Inside Mount (side view)

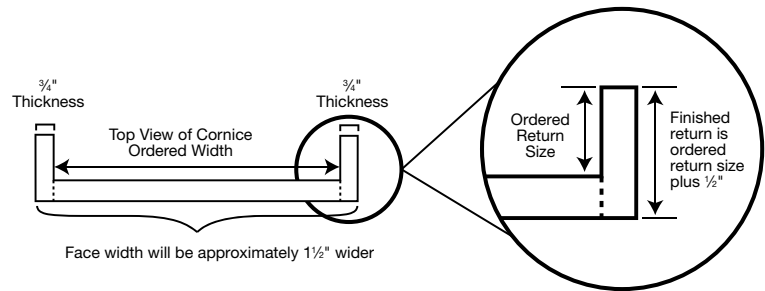

Fabric-Wrapped Cornices

Measure Notes:

- Determine inside or outside mount
- Outside mount face width on the curved cornice will be approximately $2\frac{1}{2}$ " wider than the ordered width
- Outside mount face width on the other fabric-wrapped cornice styles will be $1\frac{1}{2}$ " wider than the ordered width
- Inside mount will be approximately $\frac{1}{2}$ " less than the ordered width

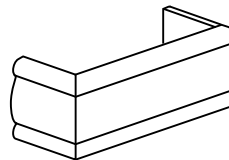

Outside Mount (side view)

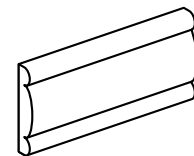

Inside Mount (side view)

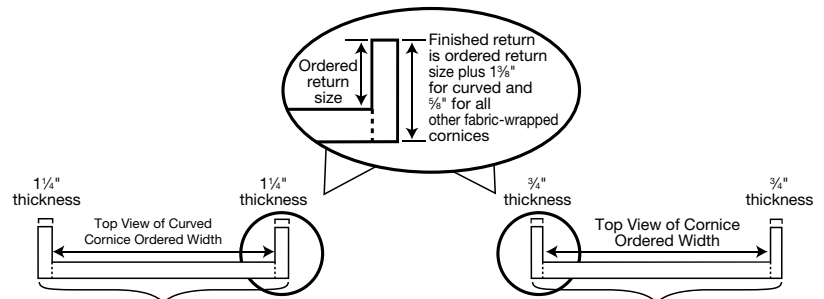

Measuring Guidelines

Tips for getting started:

1. Use a steel tape measure. Measure to the nearest $\frac{1}{8}$ ".
2. Take measurements at the top of window, as not all windows are perfectly square.
3. If ordering top treatments for multiple windows, make sure to measure each window individually.

Mounting Options

Outside Mount:

1. Measure window width including molding (see figure 1).
2. Add any additional width desired, especially if hanging curtain panels or sheers under cornice (see figure 2). Round up to the nearest full inch.
3. Recommended 2" minimum clearance on face and sides when mounting over a drapery (see figure 3).
4. Recommended 1" when mounting over inside mount treatments.

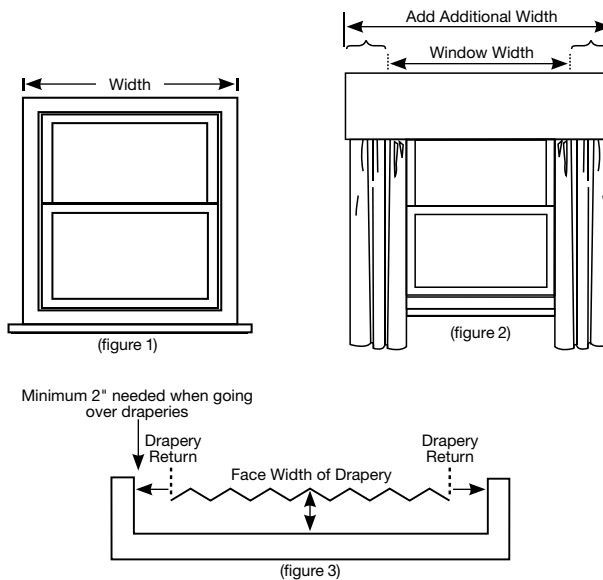

Inside Mount:

1. Measure the exact width of the window opening at the very top of the casing (see figure 4).
2. Measure the exact width of the window opening down from the top, depending on the desired length of top treatments being ordered.

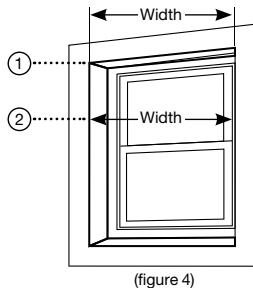

NOTE: Measure twice and document the smaller dimension, as not all window openings are perfectly square.

Bay and Corner Windows

- Available in the linear premium fabric-wrapped cornice
- Measure bay angle using protractor or angle finder, or use two business cards in bay corner as illustrated.

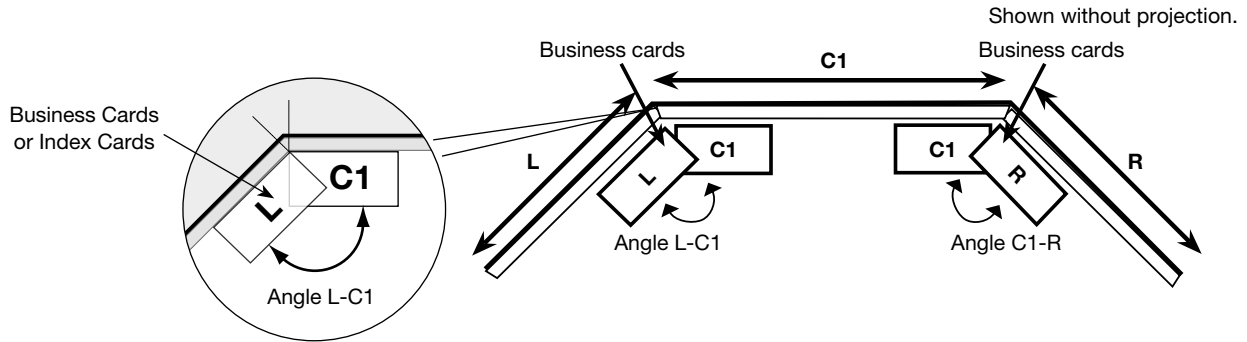

Measure:

L and R: Width of each side window from the corners on the mounting surface to the point you would like to cover.

C1: Width of the center window on the mounting surface from corner to corner.

Angle L-C1: Angle between the (L) and (C1) windows.
Angle C1-R: Angle between the (C1) and (R) windows.

Butt/Bypass—Corner Windows Only

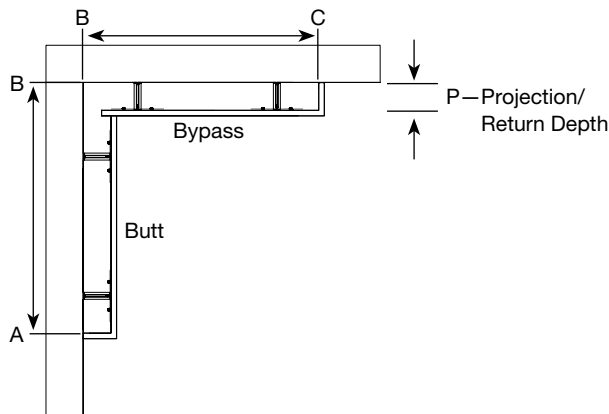

- Fabric-wrapped cornices—straight style only
- Shown as outside mount, with returns
- Outside mount projection = return depth
- Inside mount—projection is specified by the customer
- Excludes curved cornice

Measure:

Left Cornice: Width from corner (B) to the outside desired width (A).

Right Cornice: Width from corner (B) to the outside desired width (C).

Projection/

Return Depth (P): Depth from wall to back of cornice.

Choose Either: Left butt/right bypass (as shown in image) or left bypass/right butt.

NOTE: Face of cornice will be approximately $\frac{3}{4}$ " greater than the ordered projection/return measurement.